

# **Book 3D / menuiserie**

Pierre Girault - 2018





Boulangerie



Boulangerie Patisserie Sandwich



INTERDIT SAUF SAUF

Artisan  
Boulangier  
Pâtissier

Corinne et Bernard Bobes - Artisan Boulanger Pâtissier

← Rue 1347





**Agencement « L'Heure du Marché »  
7 magasins**

[lheuredumarche.com](http://lheuredumarche.com)



Parement sapin de 235 : 45 pièces  
509 : 40

Débit						
No.	Qt.	Long.	Larg.	Ep.	Mat.	
1	1	1887	1554	19	MDF	
2	1	1928	1554	19	MDF	
3	2	1648	765	19	MDF	
4	1	1118	765	19	MDF	
5	1	1362	765	19	MDF	
6	1	1817	765	19	MDF	
7	1	1554	218	19	MDF	Débit linéaire
8	2	2671	218	19	MDF	-
9	1	1362	218	19	MDF	-
10	1	1926	218	19	MDF	-
11	2	3968	35	22	Sapin	-
12	2	1148	35	22	Sapin	-
13	2	4621	35	22	Sapin	-
14	4	318	35	22	Sapin	-
15	1	1206	35	22	Sapin	-
16	1	4056	35	22	Sapin	-
17	1	4547	35	22	Sapin	-
18	1	4603	55	22	Sapin	-
19	1	1130	55	22	Sapin	-
20	1	3968	55	22	Sapin	-
21	2	300	55	22	Sapin	-
22	1	1554	1000	19	MDF	
23	2	996	765	19	MDF	

Document propriété de AD HOC Concepts, reproduction, divulgation interdites sans autorisation écrite conformément aux lois en vigueur.

Référence Agence	--		Plan		Exé. bergerie		AD HOC Concepts Boulevard Christophe Colomb 71 de Beauvais 79200 LA CRICHE Tel : 03 49 98 18 83 / Fax : 03 49 98 28 81 Email : contact@adhoc-concept.fr	
Phase	Maître d'ouvrage		Réalisé par	Pierre Grault		Echelle	1:25	
	GIE		Date	09/09/2015		Révision	20/01/2017 10-27-09	
			Indice				01	



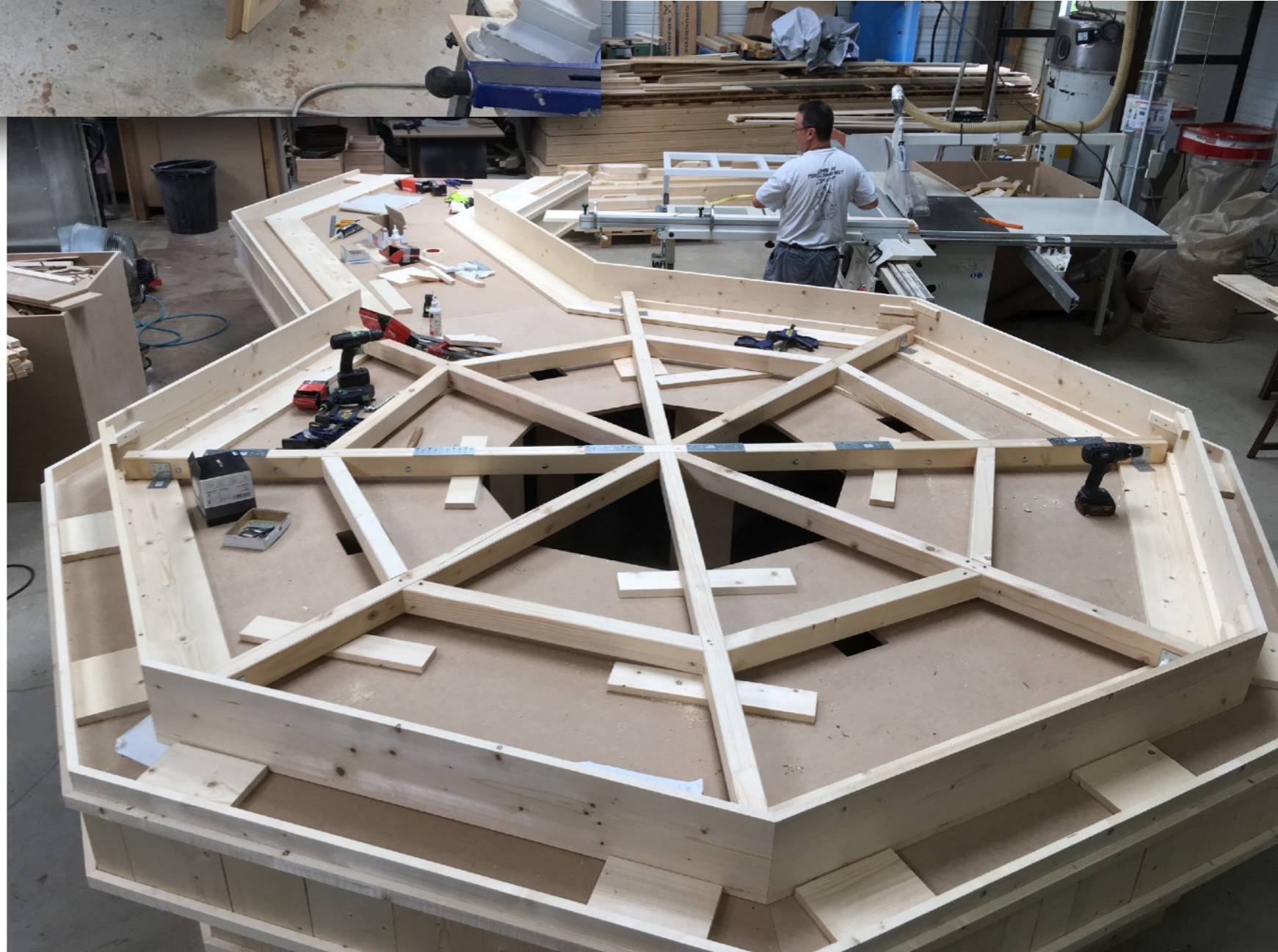

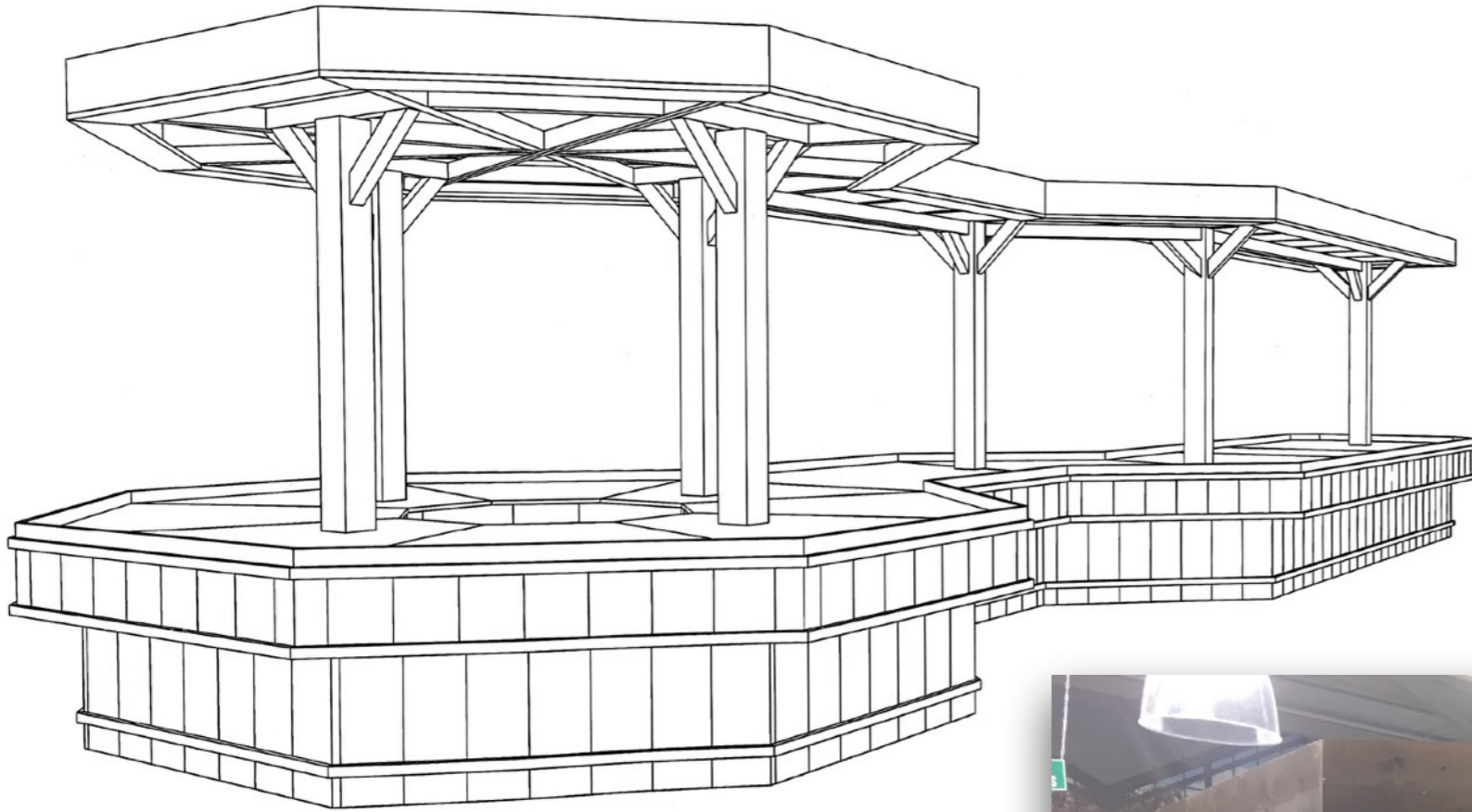



Tomate  
Cerve glappe  
France

Tomate  
grappe  
France

SALADE "Batavia"  
France

Cresson  
France

SALADE "Suvine"  
Espagne

SALADE "Lactue"  
France

...  
France

...  
France

...  
France

Two men in dark jackets and light-colored trousers are standing in the aisle, looking towards the stall. One man is slightly behind the other, and they appear to be engaged in a conversation or observing the produce.

A large wooden crate is overflowing with bright red, round tomatoes. The tomatoes are piled high, filling the left side of the stall's main display area.

The central and right portions of the stall are filled with various types of leafy greens. There are several crates of green leaf lettuce, some dark purple varieties, and other fresh herbs. The produce is neatly arranged and looks very fresh.

A row of wooden crates holds several bottles of olive oil. The bottles are clear with dark liquid inside and have simple labels. They are arranged in a neat line across the middle of the stall.

Several packages of 'DULZE' brand produce are visible. The packages are clear plastic with red and green accents, and the brand name 'DULZE' is printed in bold letters. They appear to contain small, round items like cherry tomatoes.

Two pieces of light-colored paper or parchment are tucked into the front of the wooden crate, likely containing price lists or product information for the stall.

A white plastic bag is hanging from the front of the wooden crate. The bag is crumpled and appears to be a sample or a discarded item.

A roll of clear plastic wrap is tucked into the front of the wooden crate, ready for use by customers to wrap their purchases.

A white plastic bag is hanging from the right side of the wooden crate, similar to the one on the left.





[Animation - 1mn](#)

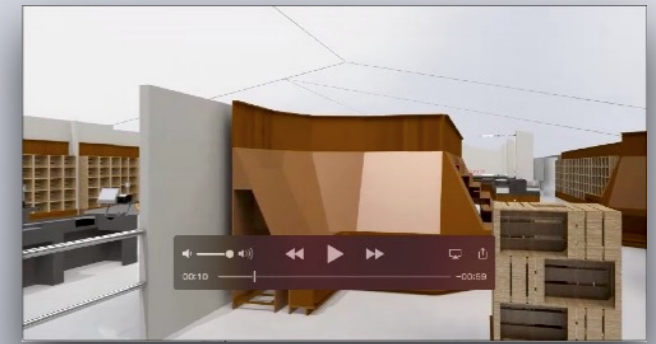



Technique mixte : dessin / Photoshop / Illustrator





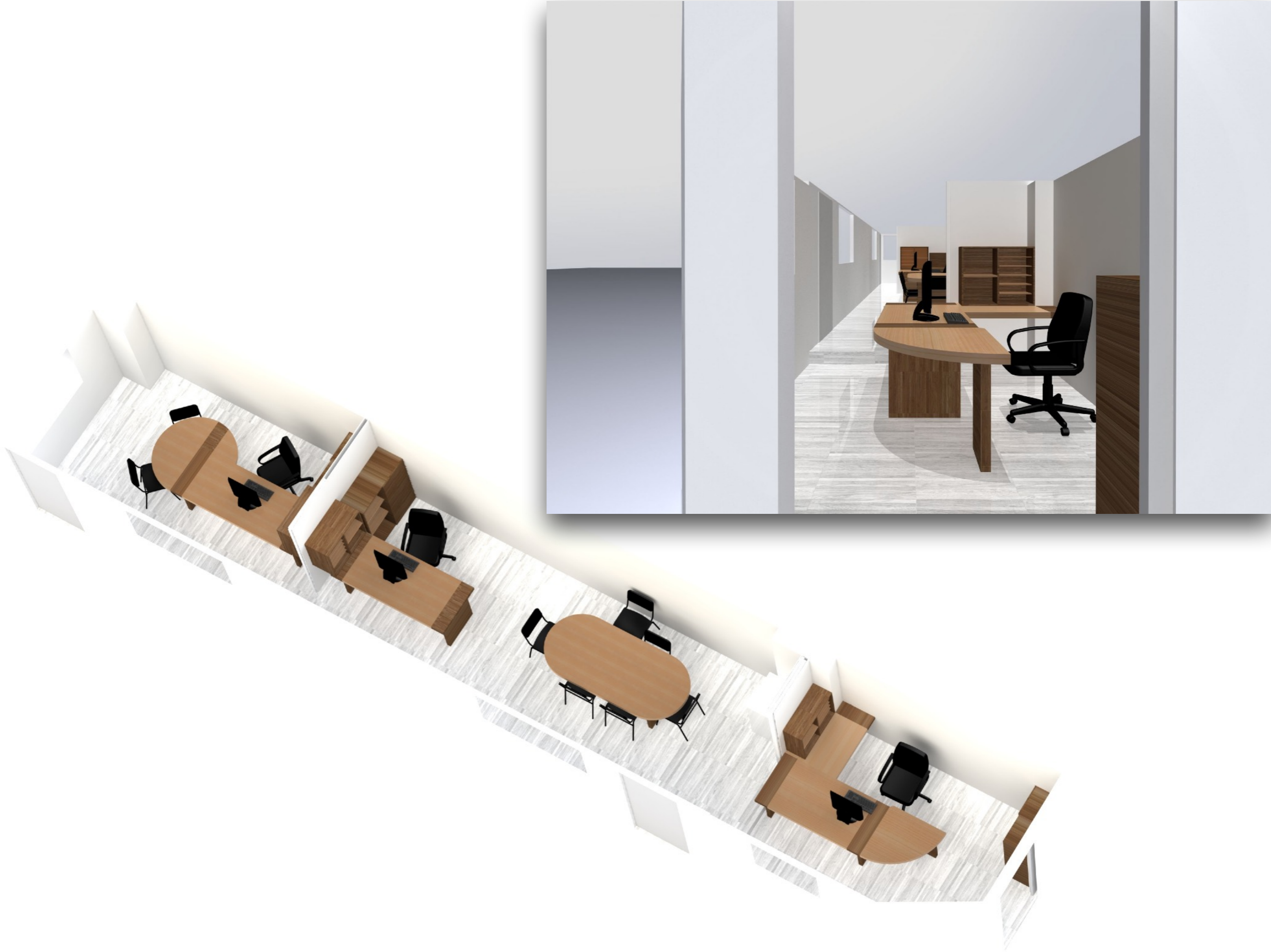







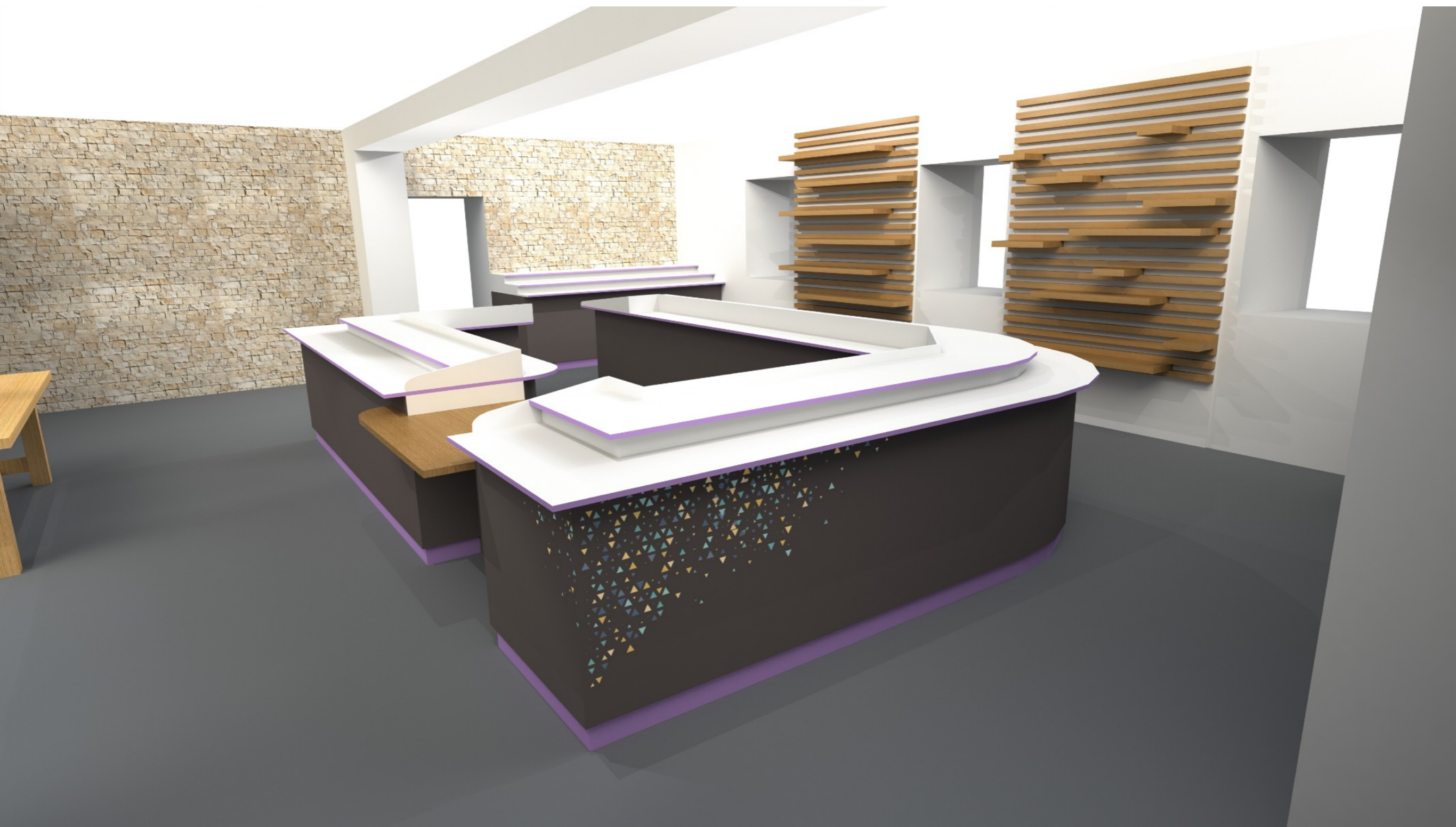

**Projet de chocolaterie**

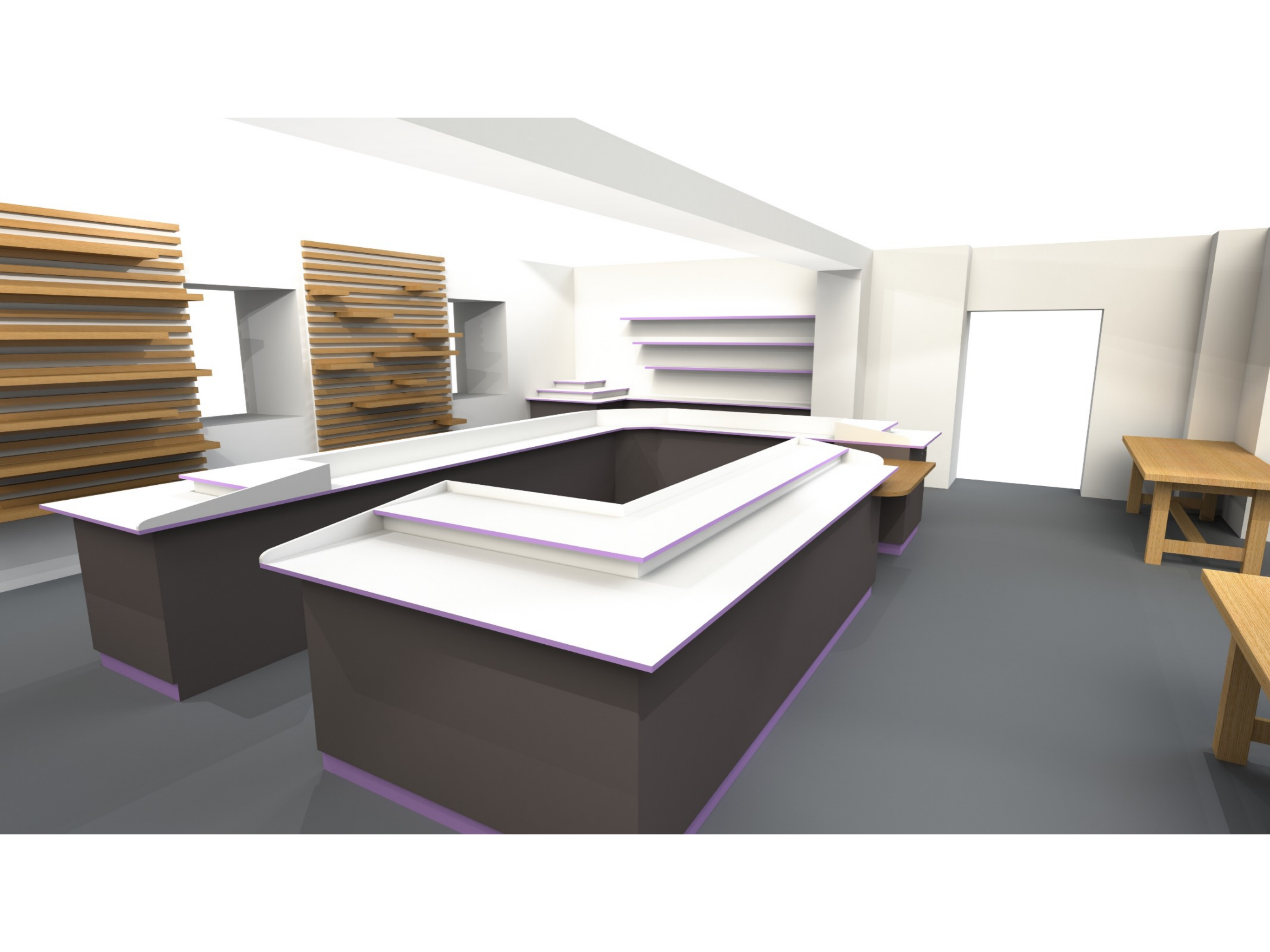

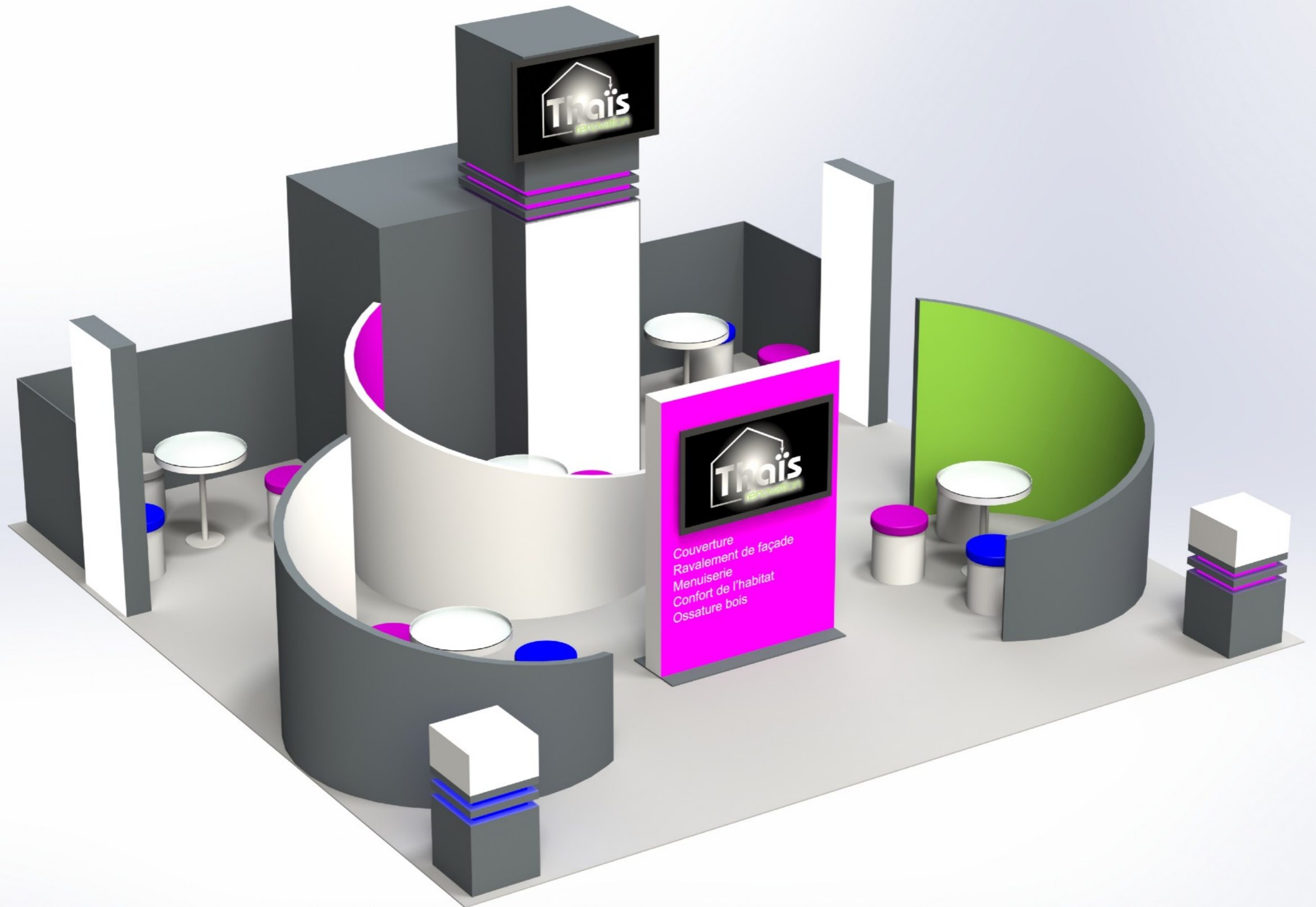

Thais  
renovation

Thais  
renovation

Couverture  
Ravalement de façade  
Menuiserie  
Confort de l'habitat  
Ossature bois

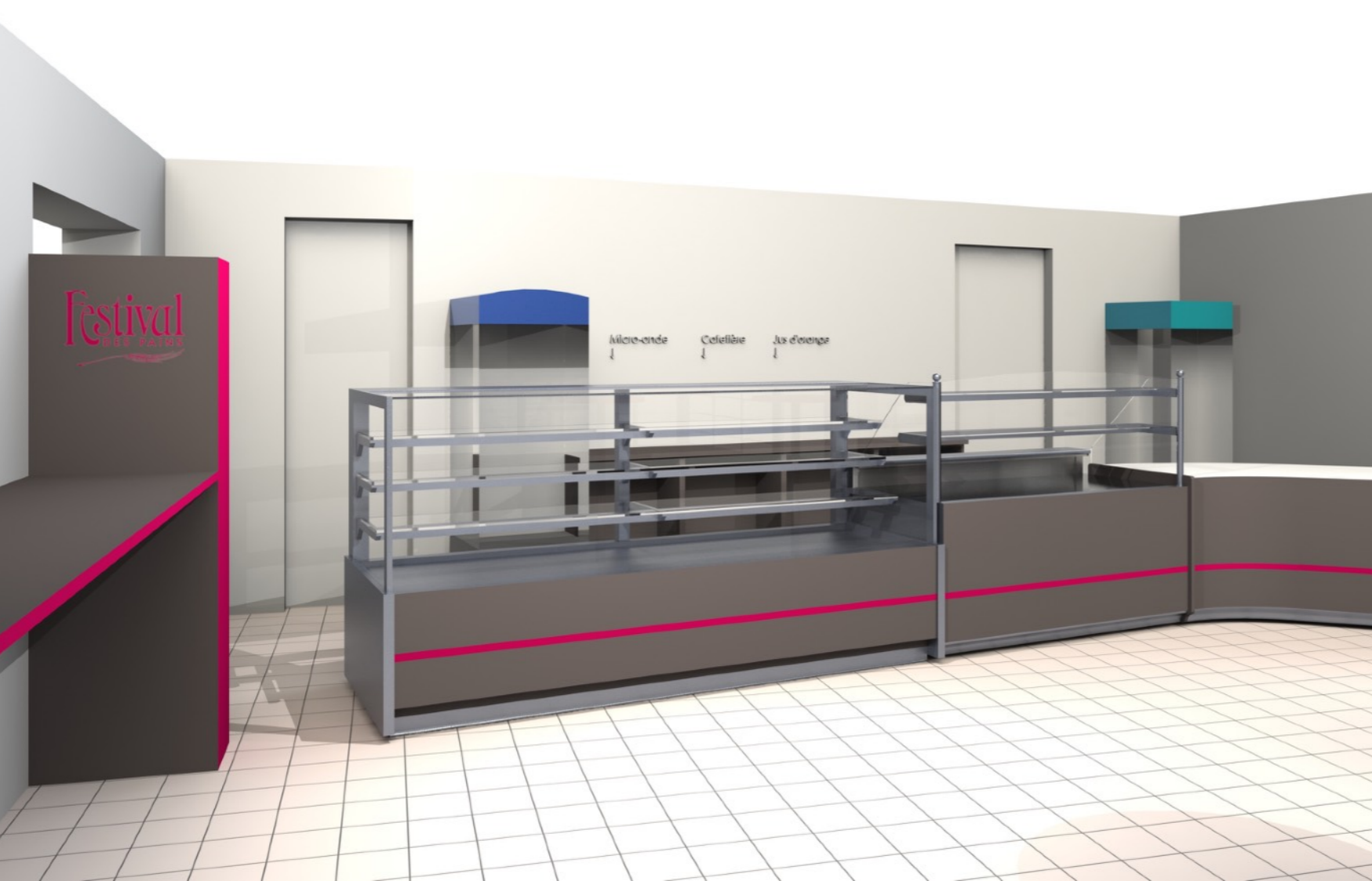

Animation - 20 s.



**Projet de boulangerie**

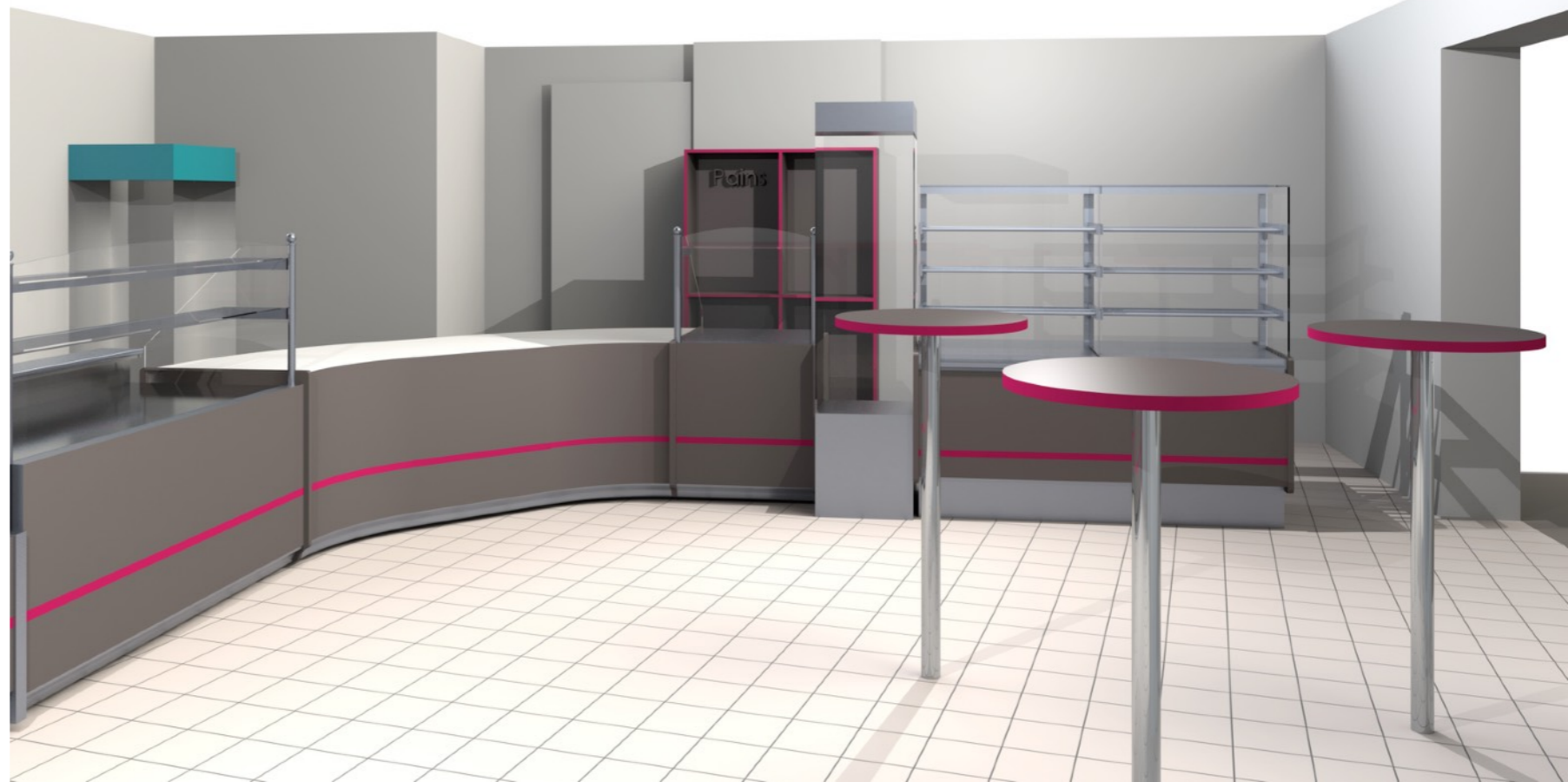

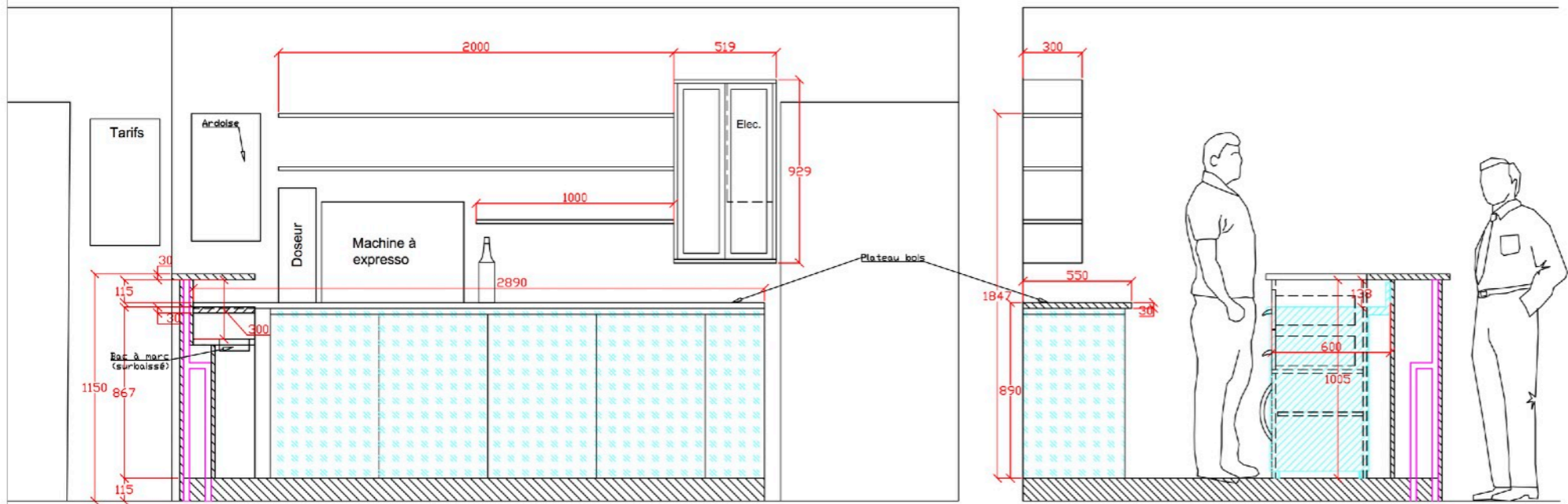

Coupe AA

# Projet de café / bar

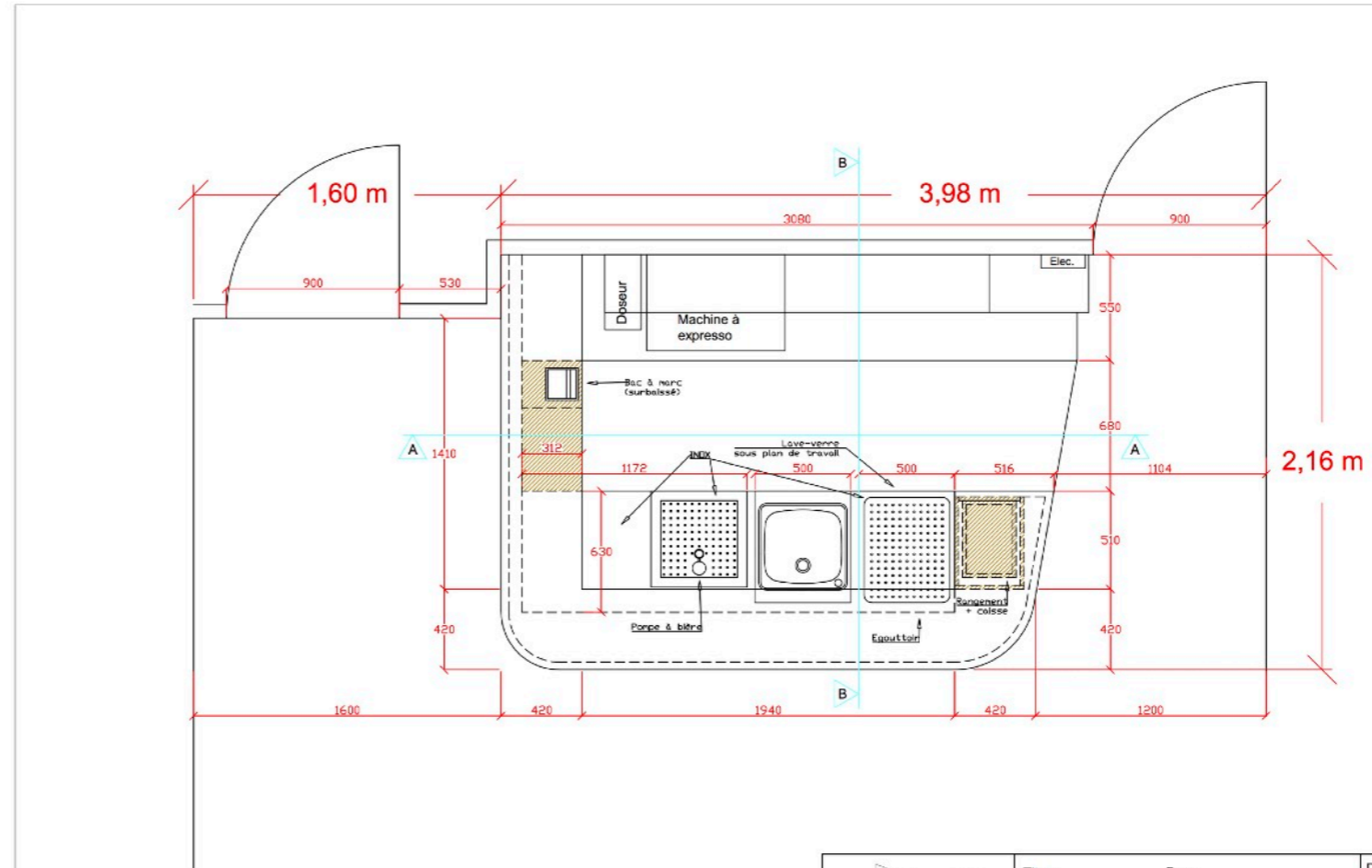

Titre :	Bar	Date :	14/02/2018
Chantier :	Bar de la poste - Mougou	Version :	1
Phase :	AP	Ech. :	1/20
Dessinateur :	Pierre Girault	Format :	A3
		Feuille :	N°1



Projet d'îlot extensible

